

# DRY PIT System

by JEMA

This new product from JEMA AGRO is a modular build, sunken intake pit. Dry Pit has been developed in order to avoid water in the intake pit, and in order to optimize the conditions for servicing the conveyor.

Dry Pit is sunk freely in a concrete pit with vertical sides, and it is built in sections of galvanized steel plates which are bolted together. Dry pit can be supplied as a drive-over version or a walk-on version. It has a standard width of 3 m., and is available in 3 depths. Dry Pit can be supplied in lengths from 4 m. The lengths can be extended by 2 m. up to 20 m.

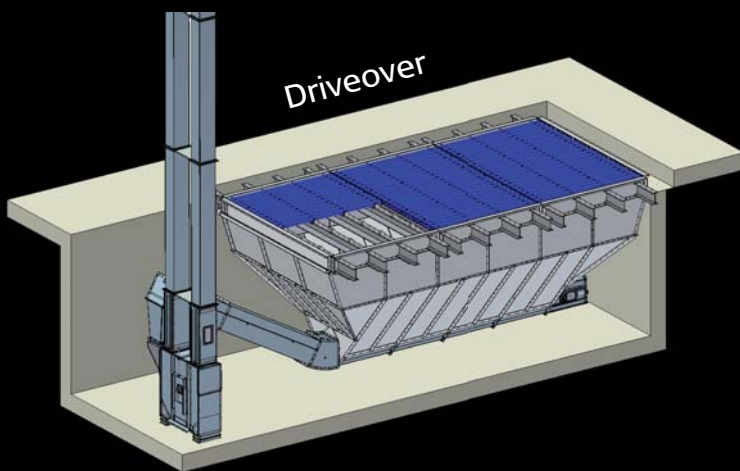

## DRY PIT System

by JEMA

- Dry Pit is to be bolted together.
- Dry Pit fits with JEMA AGRO chain and flight conveyors T45 – 49 – 57.
- Dry Pit is to be sunk in a concrete pit with vertical sides. Finally the edges are closed with cement.
- No horizontal surfaces.

## DRY PIT System

by JEMA

- Dry Pit is available with a capacity from 12.7 – 48.3 m<sup>3</sup>
- Easy fitting.
- No after adjustments for machines.
- Always dry intake conveyor.
- Clean intake pit.

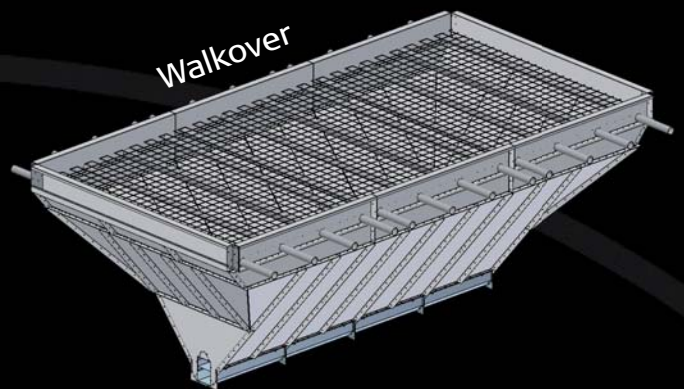

## DRY PIT System

by JEMA

- There will always be a Dry Pit to fit your requirements.
- Long lifetime of transport system.
- Easy fitting = reduced fitting costs.
- Clean Dry Pit = healthy products / clean elements for feedstuff.

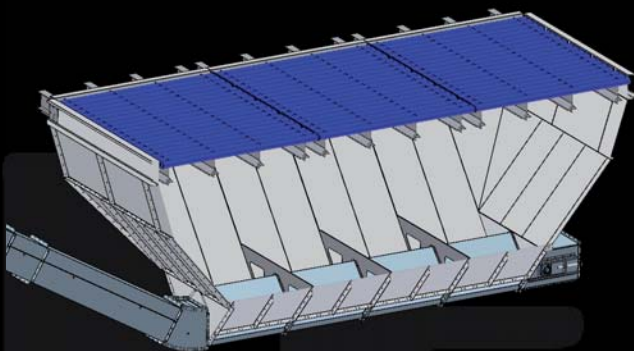

JEMA AGRO A/S  
Kløservejen 2, Sahl  
8850 Bjerringbro  
Tel.: 86 68 16 55  
Fax: 86 68 00 74  
www.jema.as

## Capacities / dimensions overall

Pit type	Capacities by steel pit length (L) x 3 m			Depth (D) m by type of pit			The length of the concrete pit (A) depends of the transport system after the Dry pit	Concrete pit with min. (C)
	4x3 m	6x3 m	8x3 m	T57	T49	T45		
DRY PIT 1	12,7 m <sup>3</sup>	20,7 m <sup>3</sup>	28,7 m <sup>3</sup>	2,33	2,40	2,53	depends of the transport system after the Dry pit	3,13 m
DRY PIT 2	17,6 m <sup>3</sup>	28 m <sup>3</sup>	38,5 m <sup>3</sup>	2,73	2,79	2,93		3,13 m
DRY PIT 3	22,5 m <sup>3</sup>	35,4 m <sup>3</sup>	48,3 m <sup>3</sup>	3,15	3,22	3,36		3,13 m

